

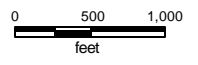

Old Brooklyn

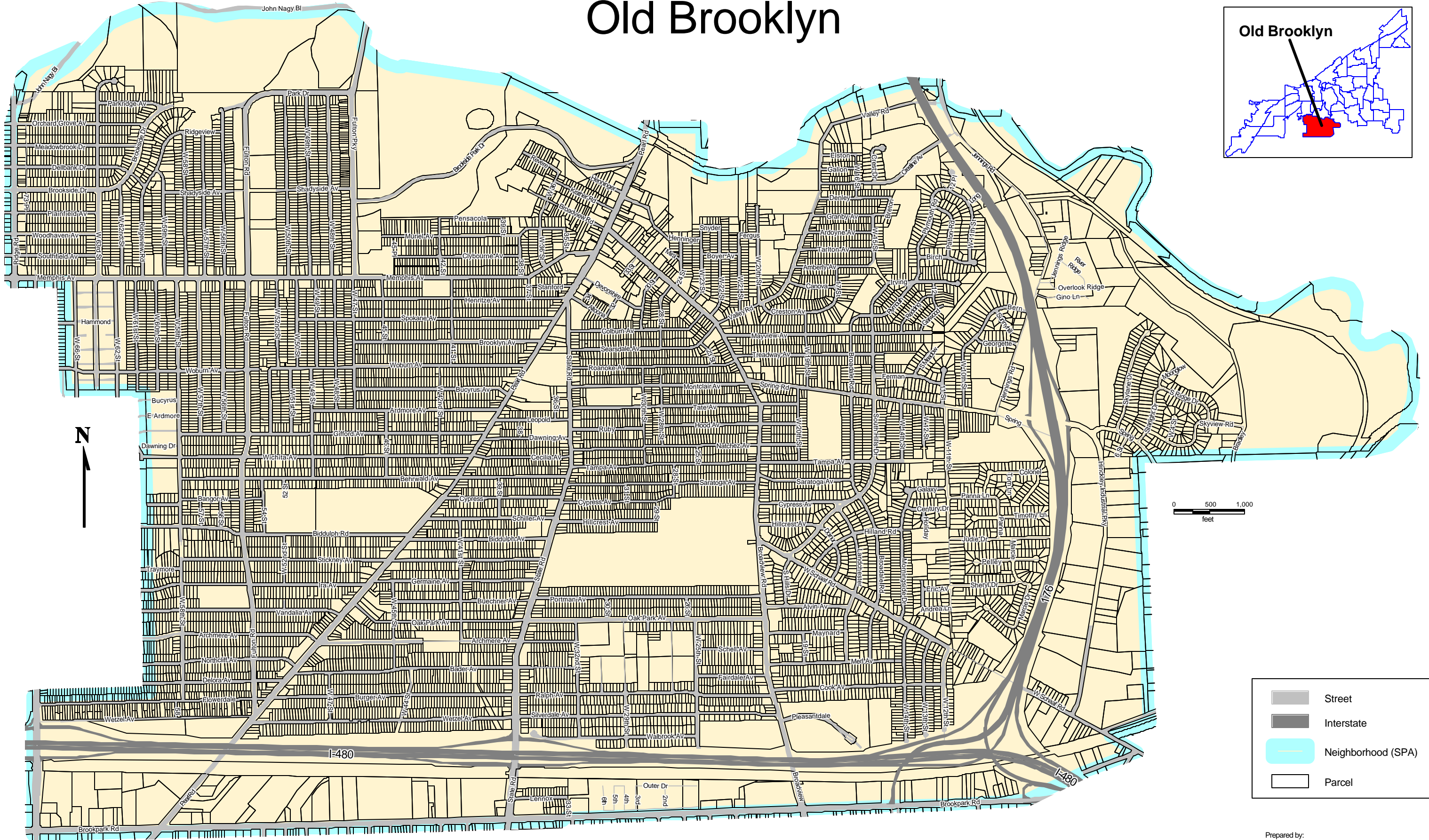
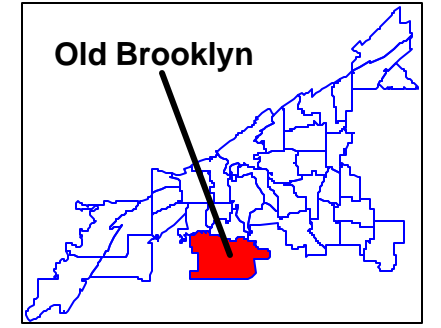

	Street
	Interstate
	Neighborhood (SPA)
	Parcel

Source:
 NODIS, 2000 (Conflated TIGER Street)
 Cleveland Planning Commission, 2002 (SPA-Neighborhood)
 Cuyahoga County Engineer's Office, 1993 (Street Pavement)
 Cuyahoga County Auditor's Office (Parcel)

Prepared by:
 Northern Ohio Data & Information Service (NODIS)
 Maxine Goodman Levin College of Urban Affairs
 Cleveland State University
 (216) 687-2210 <http://nodisnet1.urban.csuohio.edu>

Prepared 4/17/07 AD